



Insert switch KB-01-KT (replacement for Kedu KJD17, DKLD DZ-6)

Manufacturer: Klinger & Born
Type: 40700001
Product no.: 40700001
Weight: 0.100

■ Details

2-pole insert switch with undervoltage release for machines and stationary power tools

■ Properties

- 2-pole on-off-switch with Tastenoperation
- Undervoltage release
- Optionally with or without coil connection
- With splash water proof cover
- Flat seal towards installation opening
- Usable as a replacement for Kedu KJD17F and DKLD DZ-6

■ Replacement for Kedu KJD17 and DKLD DZ-6 (note the dimensions)

The switch can be used as a replacement for the switch Kedu KJD17 and DKLD DZ-6 (Yue Qing Dongke Electron).

Please note the installation dimensions. There are many variants of this switch.

■ Available with and without coil connection

The switch with coil connection has 5 connections, the one without coil connection has 4 connections (refer to image).

With the help of the coil connection, the switch can be externally triggered using emergency stop-switches or thermal contacts.

Due to the zero voltage release, the switch triggers on voltage drop (power failure) and has to be switched back on manually. Therefore it won't switch on spontaneously and uncontrollably.

■ Specifications

Voltage	230V~
Rated frequency	50Hz
Operating mode	Continuous operation
Operating current Ie	AC-1 Ue:230V 16.0A, AC-3 Ue:230V 14,5A
Pole number	2 (N/O contacts)
Switching frequency	120 operations / hour
Contacts	Positively driven
Type of actuation	Mechanically on/off
Electrical service life	50.000 switching cycles
Ambient temperature	-25°C . +60°C
Protection class	Front side IP54
Mounting position	Any
Housing material	Plastic PA
Installation	

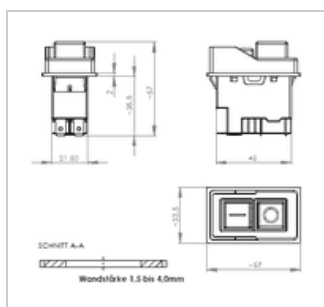
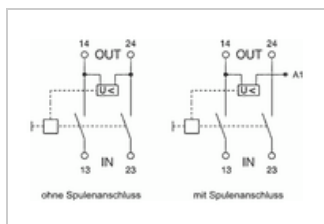

	Snap-on frame
Connection	Flat plug 6.3x0,8 mm
Corresponds to	IEC947-4-1, EN60947, DIN VDE 0660 part 102
Mark of conformity	VDE-mark of conformity, Reg.Nr. 136105

