

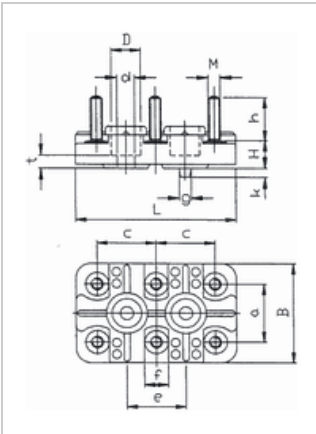

Motor terminal board KL 231, 6-pole, M5

Manufacturer:	Geiss
Type:	753S
Product no.:	KL231
Weight:	0.020



■ Details

motor terminal board with mounting holes and fastening spigot (refer to image). Suitable for electric motors from Siemens, Flender ATB Loher.

Please note the measurement from the spigot to the middle of the hole. The spigot can break if the dimensions are incorrect. There are similar terminal boards with smaller dimensions .

■ Scope of supply

The terminal board is pre-assembled with connection washers according to DIN 46228 and nuts shipped, optionally without or with 3 connection bridges.

■ Dimensions in mm (refer to dimension sheet)

L	B	M	H	H	A	E	DØ	DØ	T
66	40	M5	13	19	23	23	10	5,5	7



■ Specifications

bolt-Ø	M5
basic body	66 x 40 mm
Hole spacing	23 mm
permitted continuous current	25 A
Nuts-tightening torque	2 Nm
terminal designation	W2-U2-V2 U1-V1-W1

