

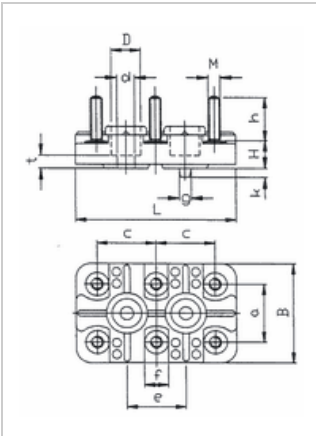

Motor terminal board KL 240, 6-pole, M4

Manufacturer: Geiss
Type: 743S
Product no.: KL240
Weight: 0.020



■ Details

motor terminal board with mounting holes and fastening spigot (refer to image), suitable for electric motors from Siemens, Flender ATB Loher.

scope of supply with nuts, connection washers according to DIN 46288, optionally with or without bridges (3 items)

Please note the measurement from the spigot to the middle of the hole. The spigot can break if the dimensions are incorrect. Es gibt ähnlich terminal boards with einer geringen messungsdifferenz.

■ Dimensions in mm (refer to dimension sheet)

L	B	M	H	H	A	E	DØ	DØ	T
43	27	M4	10	13.5	16	16	8	4,5	5

■ Specifications

bolt-Ø	M4
basic body	43 x 27 mm
Hole spacing	16 mm
permitted continuous current	16 A
Nuts-tightening torque	1,2 Nm
terminal designation	W2-U2-V2 U1-V1-W1

