

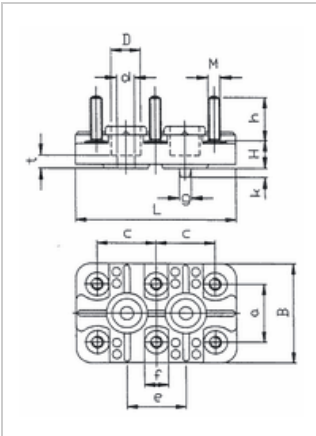

Motor terminal board KL 241, 6-pole, M5

Manufacturer: Geiss
Type: 751S
Product no.: KL241
Weight: 0.020



■ Details

motor terminal board with mounting holes and fastening spigot (refer to image)

Suitable for electric motors from Siemens, Flender ATB Loher.

■ Important

The borespacing im Motor muss genau 20 mm betragen. A deviation can break the spigot on the terminal board.

■ scope of supply

scope of supply with nuts, connection washers according to DIN 46288, optionally without or with 3 bridges.

■ Dimensions in mm (refer to dimension sheet)

L	B	M	H	H	A	E	DØ	DØ	T
54	34	M5	13	19	20	20	9,5	5,3	8

■ Specifications

bolt-Ø	M5
basic body	54 x 34 mm
Hole spacing	20 mm
permitted continuous current	25 A
Nuts-tightening torque	2 Nm
terminal designation	W2-U2-V2 U1-V1-W1

