

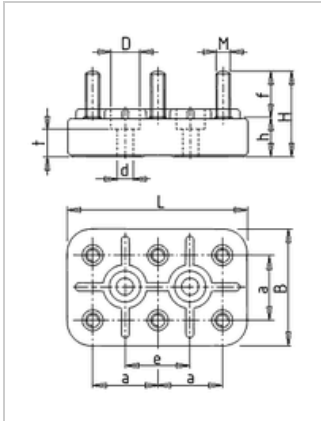

Motor terminal board KL 2 K, 6-pole, M5

Manufacturer: Geiss
Type: 2S
Product no.: KL2K
Weight: 0.070



■ Details

terminal board M5 with borespacing for the installation 20 mm.

■ Scope of supply

scope of supply with nuts and connection washers DIN 46288, optionally without or with 3 connection bridges.

■ Dimensions in mm (refer to dimension sheet)

| L | B | M | H | H | F | A | E | DØ | DØ | T |
|----|----|----|------|------|----|----|----|-----|-----|---|
| 56 | 36 | M5 | 26,5 | 11,5 | 15 | 20 | 20 | 9,5 | 5,5 | 7 |

■ Specifications

| | |
|-------------------------------------|----------------------|
| bolt-Ø | M5 |
| basic body | 36 x 56 mm |
| Hole spacing | 20 mm |
| permitted continuous current | 25 A |
| Nuts-tightening torque | 2 Nm |
| terminal designation | W2-U2-V2 U1-V1-W1 |