

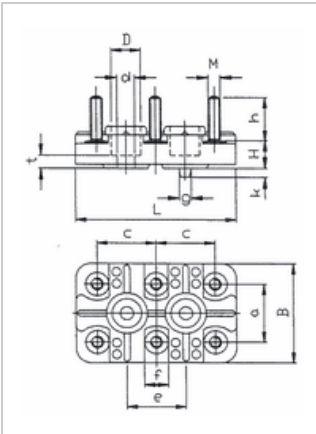

Motor terminal board KL 91, 6-pole, M4

Manufacturer:	Geiss
Type:	744S
Product no.:	KL91
Weight:	0.020



■ Details

motor terminal board with mounting holes and fastening spigot (refer to image). Suitable for electric motors from Siemens, Flender ATB Loher.

Please note the measurement from the spigot to the middle of the hole. The Zapfen kann abbrechen, wenn dieses measurement not korrekt ist.

■ scope of supply

The terminal board is pre-assembled with washers according to DIN 46228 and nuts shipped, optionally without or with 3 connection bridges.

■ Dimensions in mm (refer to dimension sheet)

L	B	M	H	H	A	E	DØ	DØ	T
54	34	M4	11	15,5	20	20	10	5,3	5



■ Specifications

bolt-Ø	M4
basic body	54 x 34 mm
Hole spacing	20 mm
permitted continuous current	16 A
Nuts-tightening torque	1,2 Nm
terminal designation	W2-U2-V2 U1-V1-W1

