

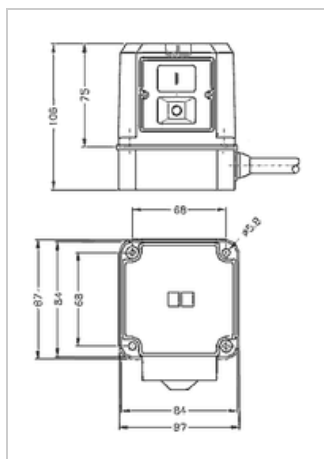

Three-phase A.C.-motor switch up to 4 kW

| | |
|---------------|-------------------|
| Manufacturer: | Klinger & Born |
| Type: | K900/NKA12/KA12/P |
| Product no.: | MS820 |
| Weight: | 0.770 |

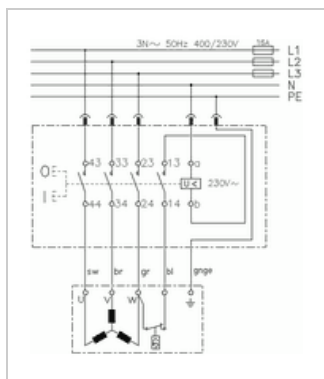

■ Details

Switch with undervoltage release and on the mainsem cable connection. suitable for circular saws, planing machines, shredders or other machines and motors, which after power failure and power recovery are not allowed to turn back on.

■ Properties

- 3-pole switch **For mains connection with neutral conductor**
- Switching capacity up to 4 kW
- Undervoltage release
- Connection possibility for thermal contact
- Including splash water proof cover

■ Suitability

The neutral conductor is not routed to the motor.

Not suitable for mains connection without neutral conductor and motors, which for example need a voltage of 230V in the terminal box for a electromechanical brake.

■ Installation / connection (refer to wiring diagram)

The switch is screwed on the housing base. Grid dimension of the screws: 68 x 68 mm. The cable outlet is on the side of the housing base, by factory setting on the opposite side of the keypad. by rotating the base, the cable can be routed to all 4 sides.

The blue wire is not a neutral conductor, it's the connection for the thermal contact. If the motor does not have a thermal contact, the blue wire has to be connected with the grey wire on the terminal board.

■ Specifications

| | |
|---------------------|--------------------------|
| Voltage Ue | 400 V~ |
| Current Ie | 9,0 A |
| Contactur | KB-04, 230V~ |
| Coil voltage Uc | 230 V~ |
| Switching capacity | 4.0 kW 400V~/AC-3 |
| Type of actuation | Mechanically on/off |
| Housing material | Polypropylene PP |
| Mounting position | Any |
| Protection class | IP54, splash water proof |
| Connection cable | 1 m H07RN-F G1,5 |
| Mounting dimensions | 68 x 68 mm |