

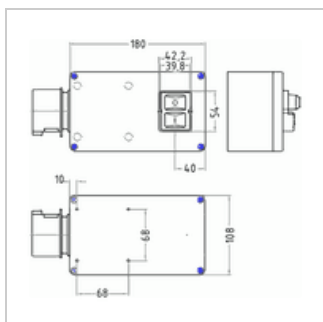

Switch-plug combination K3000/ST6/KA3 with motor protection

Manufacturer: Klinger & Born
Type: K3000/ST6/KA3/Mx.xA/Phw/P
Product no.: SSK820-1M
Weight: 0.900

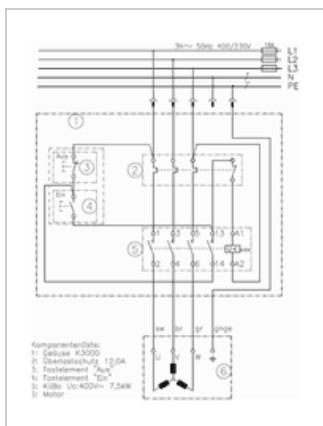

■ Details

AC switch-plug combination for circular saws, planing machines, shredders or other machines and motors, which after power failure and power recovery are not allowed to turn back on.

■ Properties

- 3-pole switching, suitable for mains connection without neutral conductor
- Switching capacity up to 7.5 kW
- Motor protection depending on the construction 12 or 16 A, **Non-adjustable**
- Undervoltage release
- Phase inverter
- Splash water proof cover

■ Suitability

The neutral conductor is not connected.

Not suitable for motors in delta connection, which for example need a voltage of 230V in the terminal box for a electromechanical brake.

If needed a brake can be tapped between a phase and a star point 230V for motors in star connection.

■ Motor protection

The motor protection has to be selected according to the nominal current of the motor (+ ca. 10%). A connection for a thermal contact is not provided, because the motor is better protected with the overcurrent protection.

■ Installation

The switch is screwed on the housing base. Grid dimension of the screws: 68 x 68 mm. The cable outlet is on the side of the housing like shown.

■ Specifications

Voltage Ue	400 V~
Current Ie	16.0 A
Contactor	U-spg. 7.5kW, 400V~
Switching capacity	7.5 kW 400V~/AC-3
Type of actuation	Mechanically on/off
Connector	CEE 3P+N+E , 16A
Housing material	Polypropylene PP
Mounting position	Any
Protection class	IP54, splash water proof
Connection cable	1 m H07RN-F G1,5
Mounting dimensions	68 x 68 mm

