

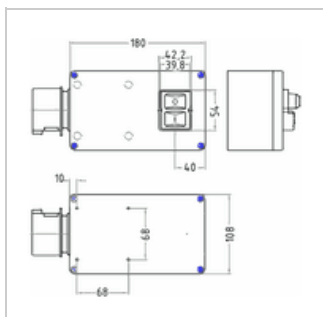

Switch-plug combination K3000 with brake, Motor protection 12A

Manufacturer: Klinger & Born
Type: K3000/B/ST6/KA3/M12.0/Phw/P
Product no.: SSK850-12A
Weight: 1.050

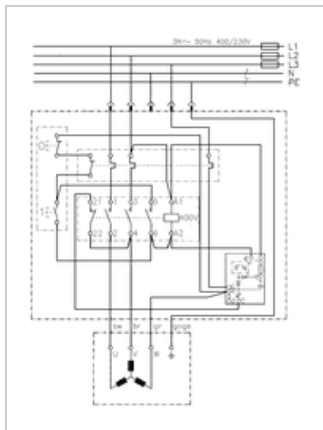

■ Details

Switch-plug combination for three-phase A.C. Current. for circular saws, planing machines, shredders or other machines and motors, which after power failure and power recovery are not allowed to turn back on.

Required for machines for commercial operation, which do not have an engine brake, but are required to have one.

■ Properties

- 3-pole switching. Suitable for mains connection without neutral conductor
- Switching capacity up to 7.5 kW
- Braking electronics, braking current up to 16 A adjustable
- Motor protection , **Non-adjustable**
- Undervoltage release
- Phase inverter
- Splash water proof cover

■ Suitability

The neutral conductor is not connected.

Not suitable for motors in delta connection, which for example need a voltage of 230V in the terminal box for a electromechanical brake.

If needed a brake can be tapped between a phase and a star point 230V for motors in star connection.

■ Motor protection

The motor protection is according to the nominal current des Motors (+ ca. 10%)auszuwählen.

A connection for a thermal contact is not provided, because the motor is better protected with the overcurrent protection.

■ Installation / connection (refer to wiring diagram) / brake

The switch is screwed on the housing base. Grid dimension of the screws: 68 x 68 mm.

The brake is by factory setting set to the lowest current. The braking current can be adjusted with a potentiometer.

■ Specifications

Voltage Ue	400 V~
Current Ie	16.0 A
Contactora	U-spg. 7.5kW, 400V~
Switching capacity	7.5 kW 400V~/AC-3
Braking current	Up to 16A adjustable
Type of actuation	Mechanically on/off
Connector	CEE 3P+N+E , 16A
Housing material	Polypropylene PP
Mounting position	

	Any
Protection class	IP54, splash water proof
Connection cable	1 m H07RN-F G1,5
Mounting dimensions	68 x 68 mm

Alle variants dieses switches: [Schalter-Stecker-Kombination K3000/ST6 mit Bremse, Motorschutz](#)